

vtech[®]

Instruction Manual

First Responder Smart Rescue Set™



INTRODUCTION

Thank you for purchasing the **First Responder Smart Rescue Set™**! This playset includes 15 play pieces for interactive play. Put on the dress-up first responder costume, pick up the interactive healthcare tablet, and let's play!

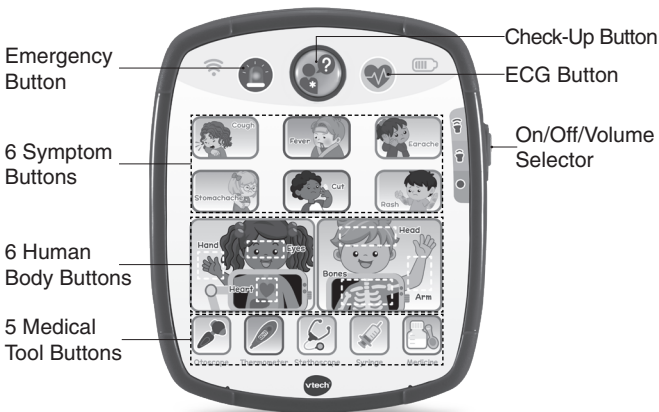

INCLUDED IN THE PACKAGE

- **First Responder Smart Rescue Set™**
- Quick Start Guide



• First Responder Costume



• Medical Bag



• Stethoscope



• Otoscope



• Syringe



• Thermometer



• Tweezers



• Mirror



• Scissors



• Flashlight



• Walkie-Talkie



• Medicine Bottle



• Glasses



• Bandage



• Healthcare Tablet

WARNING

All packing materials such as tape, plastic sheets, packaging locks, removable tags, cable ties, cords and packaging screws are not part of this toy and should be discarded for your child's safety.

NOTE

Please save this Instruction Manual it contains important information.

ATTENTION

Pour la sécurité de votre enfant, débarrassez-vous de tous les produits d'emballage tels que rubans adhésifs, feuilles de plastique, attaches, étiquettes, cordons et vis d'emballage. Ils ne font pas partie du jouet.

NOTE

Il est conseillé de sauvegarder ce manuel d'utilisation car il comporte des informations importantes.

Unlock the Packaging Locks

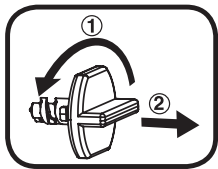

- ① Rotate the packaging locks 90 degrees counterclockwise.
- ② Pull out the packaging locks.

INSTRUCTIONS

Battery Removal and Installation

1. Make sure the unit is turned **Off**.
2. Find the battery cover located on the back of the unit. Use a screwdriver to loosen the screw, and then open the battery cover.
3. Remove old batteries by pulling up on one end of each battery.
4. Install 2 new AA batteries following the diagram inside the battery box. (For best performance, alkaline batteries or fully charged Ni-MH rechargeable batteries are recommended.)
5. Replace the battery cover and tighten the screw to secure.

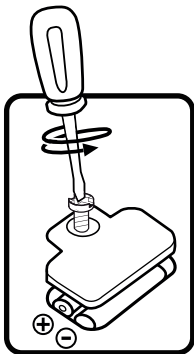

WARNING:

Adult assembly required for battery installation.
Keep batteries out of reach of children.



ATTENTION :

Les piles ou accumulateurs doivent être installés par un adulte.
Tenir les piles ou accumulateurs hors de portée des enfants.

IMPORTANT: BATTERY INFORMATION

- Insert batteries with the correct polarity (+ and -).
- Do not mix old and new batteries.
- Do not mix alkaline, standard (carbon-zinc) or rechargeable batteries.
- Only batteries of the same or equivalent type as recommended are to be used.
- Do not short-circuit the supply terminals.
- Remove batteries during long periods of non-use.
- Remove exhausted batteries from the toy.
- Dispose of batteries safely. Do not dispose of batteries in fire.

RECHARGEABLE BATTERIES

- Remove rechargeable batteries (if removable) from the toy before charging.
- Rechargeable batteries are only to be charged under adult supervision.
- Do not charge non-rechargeable batteries.

IMPORTANT : INFORMATIONS CONCERNANT LES PILES

- Mettre en place les piles ou les accumulateurs en respectant les polarités + et –.
- Ne pas mélanger des piles ou des accumulateurs neufs avec des usagés.
- Ne pas mélanger différents types de piles : alcalines, zinc-carbone et rechargeables.
- Seules des piles du type recommandé doivent être utilisées.
- Ne pas mettre les bornes d'une pile ou d'un accumulateur en court-circuit (en reliant directement le + et le –).
- Retirer les piles ou les accumulateurs en cas de non-utilisation prolongée.
- Enlever les piles ou les accumulateurs usagés du jouet.
- Ne les jeter ni au feu ni dans la nature.

PILES RECHARGEABLES

- Enlever, lorsque c'est possible, les accumulateurs du jouet pour les recharger.
- Les accumulateurs ne doivent être chargés que sous la surveillance d'un adulte.
- Ne pas tenter de recharger des piles non rechargeables.

LABEL APPLICATION

Optional labels are included to decorate the play pieces. Please stick the labels to the tools securely as indicated below:

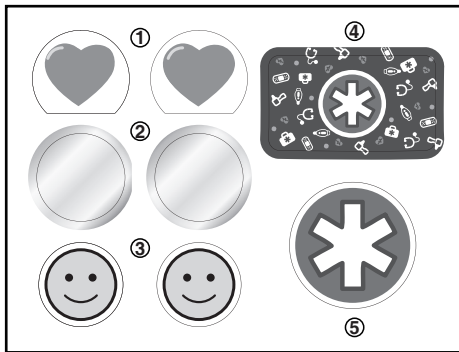

①



②



③



④



⑤

PRODUCT FEATURES

1. On/Off/Volume Selector

To turn the unit **On**, slide the **On/Off/Volume Selector** to the Low volume 🗨️ or the High volume 🗣️ position. To turn the unit **Off**, slide the **On/Off/Volume Selector** to the **Off** ● position.



2. Check-Up and Symptom Buttons

Press the **Check-Up Button** to enter Check-Up mode, or one of the six **Symptom Buttons** to learn about common illnesses. The lights will flash with the sounds.



3. Touch Icons

Press the **Emergency Button** or the **ECG Button** to hear rescue voices, fun songs and sound effects. Touch the six **Human Body Buttons** to learn about different parts of the body or the five **Medical Tool Buttons** to hear about the instruments doctors use.



4. Accessories

Use the included accessories like the **Otoscope**, **Stethoscope**, **Syringe** or **Thermometer** for even more role play fun.



5. Automatic Shut-Off

To preserve battery life, the **First Responder Smart Rescue Set™** will automatically power down after several seconds without input. The unit can be turned on again by pressing the **Check-Up Button** to enter Quiz mode.

NOTE

If the unit powers down or if the light fades out during play, please install a new set of batteries.

ACTIVITIES

1. Symptom Checker Mode

Press the six **Symptom Buttons** help kids understand common illnesses.



2. Human Body Mode

Press the six different **Human Body Buttons** to learn about each part of the body and how to help your patient.

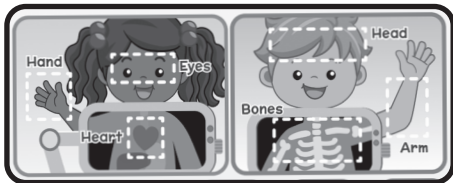

3. Learning Mode

Press the five **Medical Tool Buttons** to explore instruments doctors use and how they help people.

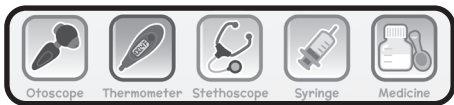

4. Quiz Mode



Press the **Check-Up Button** to enter Quiz mode and answer questions about your patient to help diagnose their illness.

5. First Responder Mode



Touch the **Emergency Button** to enter First Responder mode and hear rescue voices and rescue-themed songs.

SONGS

Song 1

There's an emergency, and we've got to go!
Hurry, hurry, zoom, zoom, zoom down the road!
Ready, steady, siren's blaring!
Lights are flashing, flashing, flashing.
Beep, beep, beep, here we come!

Song 2

We are first responders, do you know what we do?
We help out people each and every day.
We know first aid and we can put out fires.
We'll jump into action, coming when you call,
Don't be afraid to ask us for help!

Song 3

It's important to keep our bodies feeling great,
Exercising every day.
Go outside, get some fresh air and go for a walk.
Take some time for a nap and a healthy meal.

CARE & MAINTENANCE

1. Keep the unit clean by wiping it with a slightly damp cloth.
2. Keep the unit out of direct sunlight and away from any direct heat sources.
3. Remove the batteries if the unit will not be in use for an extended period of time.
4. Do not drop the unit on hard surfaces and do not expose the unit to moisture or water.
5. The first responder's costume and medical bag can be hand washed or gently machine washed. Hang to air dry.

TROUBLESHOOTING

If for some reason the unit stops working or malfunctions, please follow these steps:

1. Turn the unit **Off**.
2. Interrupt the power supply by removing the batteries.
3. Let the unit stand for a few minutes, then replace the batteries.
4. Turn the unit **On**. The unit should now be ready to use again.
5. If the unit still does not work, replace with a new set of batteries.

IMPORTANT NOTE:

If the problem persists, please call our **Consumer Services Department** at **1-800-521-2010** in the U.S., **1-877-352-8697** in Canada, or visit our website **vtechkids.com** and fill out our **Contact Us** form located under the **Customer Support** link. Creating and developing VTech products is accompanied by a responsibility that we take very seriously. We make every effort to ensure the accuracy of the information, which forms the value of our products. However, errors sometimes can occur. It is important for you to know that we stand behind our products and encourage you to contact us with any problems and/or suggestions you might have. A service representative will be happy to help you.

NOTE

This equipment has been tested and found to comply with the limits for a Class B digital device, pursuant to Part 15 of the FCC Rules. These limits are designed to provide reasonable protection against harmful interference in a residential installation. This equipment generates, uses and can radiate radio frequency energy and, if not installed and used in accordance with the instructions, may cause harmful interference to radio communications. However, there is no guarantee that interference will not occur in a particular installation. If this equipment does cause harmful interference to radio or television reception, which can be determined by turning the equipment off and on, the user is encouraged to try to correct the interference by one or more of the following measures:

- Reorient or relocate the receiving antenna.
- Increase the separation between the equipment and receiver.
- Connect the equipment into an outlet on a circuit different from that to which the receiver is connected.
- Consult the dealer or an experienced radio/TV technician for help.

CAUTION

Changes or modifications not expressly approved by the party responsible for compliance could void the user's authority to operate the equipment.

Supplier's Declaration of Conformity

47 CFR § 2.1077 Compliance Information

Trade Name: VTech®
Model: 5521
Product Name: First Responder Smart Rescue Set™
Responsible Party: VTech Electronics North America, L.L.C.
Address: 1156 W. Shure Drive, Suite 200
Arlington Heights, IL 60004
Website: vtechkids.com

THIS DEVICE COMPLIES WITH PART 15 OF THE FCC RULES. OPERATION IS SUBJECT TO THE FOLLOWING TWO CONDITIONS: (1) THIS DEVICE MAY NOT CAUSE HARMFUL INTERFERENCE, AND (2) THIS DEVICE MUST ACCEPT ANY INTERFERENCE RECEIVED, INCLUDING INTERFERENCE THAT MAY CAUSE UNDESIRE OPERATION.

CAN ICES-003(B)/NMB-003(B)

**Visit our website for more
information about our products,
downloads, resources and more.**

vtechkids.com
vtechkids.ca

Read our complete warranty policy online at
vtechkids.com/warranty
vtechkids.ca/warranty

